

LANDSCAPE CONCEPT PLAN LEGEND

- NATIVE PLANTINGS WITH SEASONAL COLOUR. 2 - 3M HIGH PLANTS USED FOR SCREENING ALONG BOUNDARIES, NONPOISONOUS, 1M HIGH LOW PLANTING USED IN CHILD PLAY AREAS AND TREES USED FOR SHADE AND HIGHLIGHTING ENTRIES AND WALKWAYS
- HIGHLIGHT PLANTS WITH YEAR ROUND FOLIAGE COLOUR TO SUBTLY DIRECT VISITORS TO THE FACILITY VEHICULAR AND PEDESTRIAN ENTRIES. HIGHLIGHT PLANTS ALSO ADD VIBRANT DETAIL TO LARGE MASS PLANTING AREAS.
- CONTRASTING EXPOSED AGGREGATE PAVING USED TO DEFINE CONGREGATING SPACES AND ADD DETAIL TO LARGE OPEN CONCRETE AREAS. EXPOSED AGGREGATE WILL BE COLOURED WITH NATURAL TONES STONES OF LOCAL PROVENIENCE.
- HARD WEARING CONCRETE PAVEMENTS USED IN AREAS OF HIGH PEDESTRIAN ACTIVITY. WHERE IMPLEMENT AS A BIKE TRACK OR WET PLAY AREA IN CHILD PLAY SPACES THE CONCRETE CAN BE DECORATED BY CHILDREN AND IN DETAIL DESIGN STAGE.
- COLOURED CONCRETE BICYCLE TRACK TO ADD COLOUR TO THE PLAYGROUND SPACE AND PROVIDE A DISTINCT PATH FOR RUNNING AND RIDING BICYCLES.
- LIMITED RUBBERISED SOFT FALL FOR LOOSE PLAY EQUIPMENT AND FIXED PLAY EQUIPMENT. PATTERNING ON SOFT FALL CURRENTLY SHOWN IS INDICATIVE ONLY. PATTERNS WILL BE DESIGNED TO SUIT AND COLOURS DETERMINED BY CONSULTATION.
- COLOURED CONCRETE WITH CONTRASTING CONCRETE PAVING PATTERNING USED TO PROVIDE SCALE AND INTEREST TO THE WALKWAYS.
- GRASSED AREAS WITH CONTRASTING GRASS SPECIES STRIPS TO CONTINUE PATTERN FROM CONCRETE WALKWAYS FOR INFORMAL PLAY AND GATHERING. GRASS IS IRRIGATED AND DESIGNED FOR A MEDIUM LEVEL OF PEDESTRIAN ACTIVITY.
- APPROVED MILLED SOFTFALL MULCH FOR IMPACT ZONES AROUND SELECTED PLAY EQUIPMENT.
- ARTIFICIAL GRASSED AREAS FOR INFORMAL PLAY AND GATHERING AND IS DESIGNED FOR A HIGH LEVEL OF PEDESTRIAN ACTIVITY.
- FINE WASHED SAND IN LINED SAND PITS. WATER CAN BE ADDED IN BOWLS OR LOW DOSE PUMPS TO EXTEND THE PLAY EXPERIENCE.
- LOW HEIGHT RETAINING WALLS FOR SLOPED AREAS AND AS INFORMAL SEATING WALLS THROUGHOUT THE CENTRE.
- OPEN STYLE CUBBY HOUSE FOR CHILDREN'S PLAY. OPEN CUBBY HOUSES HAVE TWO SIDES ONLY, AN ELEVATED DECK AND ROOF STRUCTURE TO INCREASE SURVEILLANCE BUT FACILITATE SMALL SCALE PASSIVE PLAY EXPERIENCES.
- LOW HEIGHT TIMBER PLATFORMS FOR PASSIVE PLAY AND SEATING.
- LOW HEIGHT CLIMBING WALL PLAY EQUIPMENT TO SUPPLEMENT THE NATURE PLAY BASED PLAYGROUND. LOW HEIGHT WALL IS ILLUSTRATED ON THE LANDSCAPE ELEMENTS PLAN.
- THE CENTRAL COURTYARD SPACE FEATURES A SOFT FALL PLAYGROUND WITH A COLOURED CONCRETE BIKE TRACK AND EQUIPMENT FOR CHILDREN AGED BETWEEN 2-15. PLAYGROUND EQUIPMENT IS ILLUSTRATED ON THE LANDSCAPE ELEMENTS PLAN.
- PROPOSED TREES TO ADD SHADE, SOFTEN BUILT FORM AND ADD SEASONAL CHANGE TO THE LANDSCAPE SCHEME.
- EXISTING TREES TO BE RETAINED ON SITE. FOR INFORMATION ON TREE HEALTH REFER TREE REPORT FOR NOMINATED SPECIES AND CONDITION OF TREES.

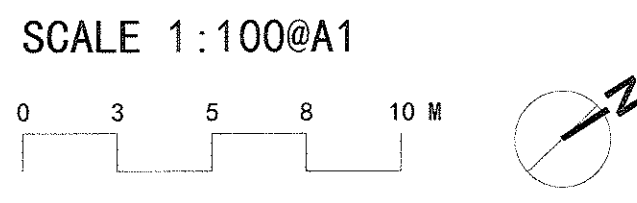

LANDSCAPE CONCEPT PHILOSOPHY

THE LANDSCAPE PHILOSOPHY IS TO PROVIDE A SCHEME THAT CAN CATER TO A WIDE VARIETY OF PEOPLES NEEDS NOW AND IN THE FUTURE. THE SPACES ARE SCALED TO ALLOW VARIOUS SIZE GROUPS TO MEET COMFORTABLY AND WITH MATERIALS SELECTED THAT ARE HARD WEARING WHERE THERE IS HIGH PEDESTRIAN ACTIVITY. OTHER SPACES HAVE SOFTER TREATMENTS TO ACCOMMODATE FALL ZONES, DIFFERING PLAY ACTIVITIES AND TO PROVIDE INTEREST. THE PLANTING AREAS ARE CREATED TO DEFINE SPACES, SCREEN AREAS AND ADD TO THE NATURE PLAY EXPERIENCE OFFERED IN THE COMMUNITY CENTRE.

LANDSCAPE CONCEPT PLAN

PROPOSED STOREY PARK COMMUNITY HALL AND CHILDCARE CENTRE
Community centre, Childcare ages 0-5, Administrative block and Parking arrangements

Sydney
Studio 12 Level 5 35 Buckingham St
Surry Hills NSW 2010
Tel +61 2 8396 9500 Fax +61 2 8396 9555
E-mail sydney@modedesign.com.au
Architect R P O'Brien Registration No 7176
Brisbane Sunshine Coast Sydney Melbourne Darwin Gold Coast

PROJECT No: 10157SYD
DATE: 29/10/2012
SCALE: 1:100@A1
DRAWING No: DD 01 OF 7
REVISION: E

FOR APPROVAL

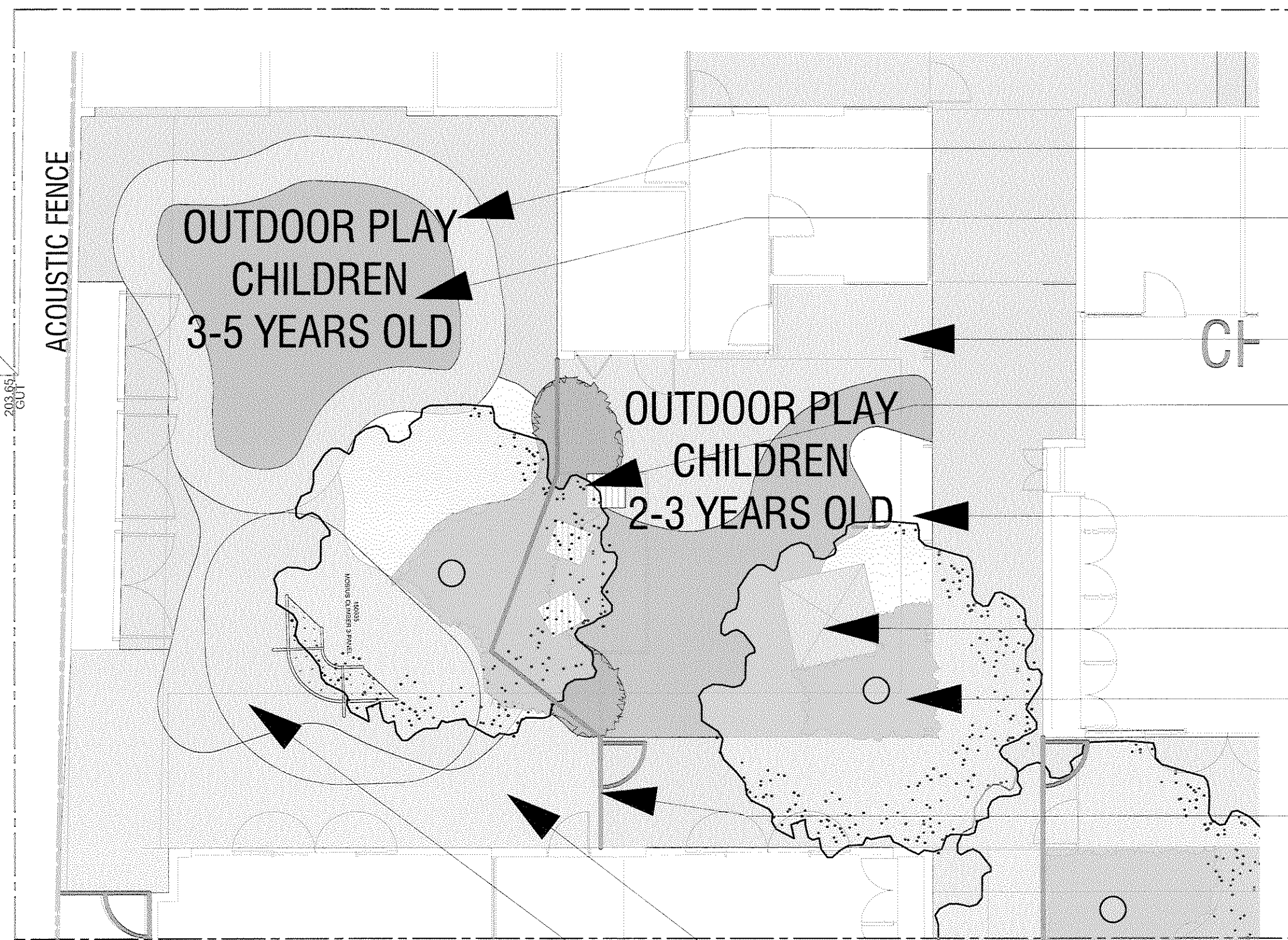

DETAIL PLAN A - CHILDCARE CENTRE

0 1 2 3 4 5 M SCALE 1:50@A1

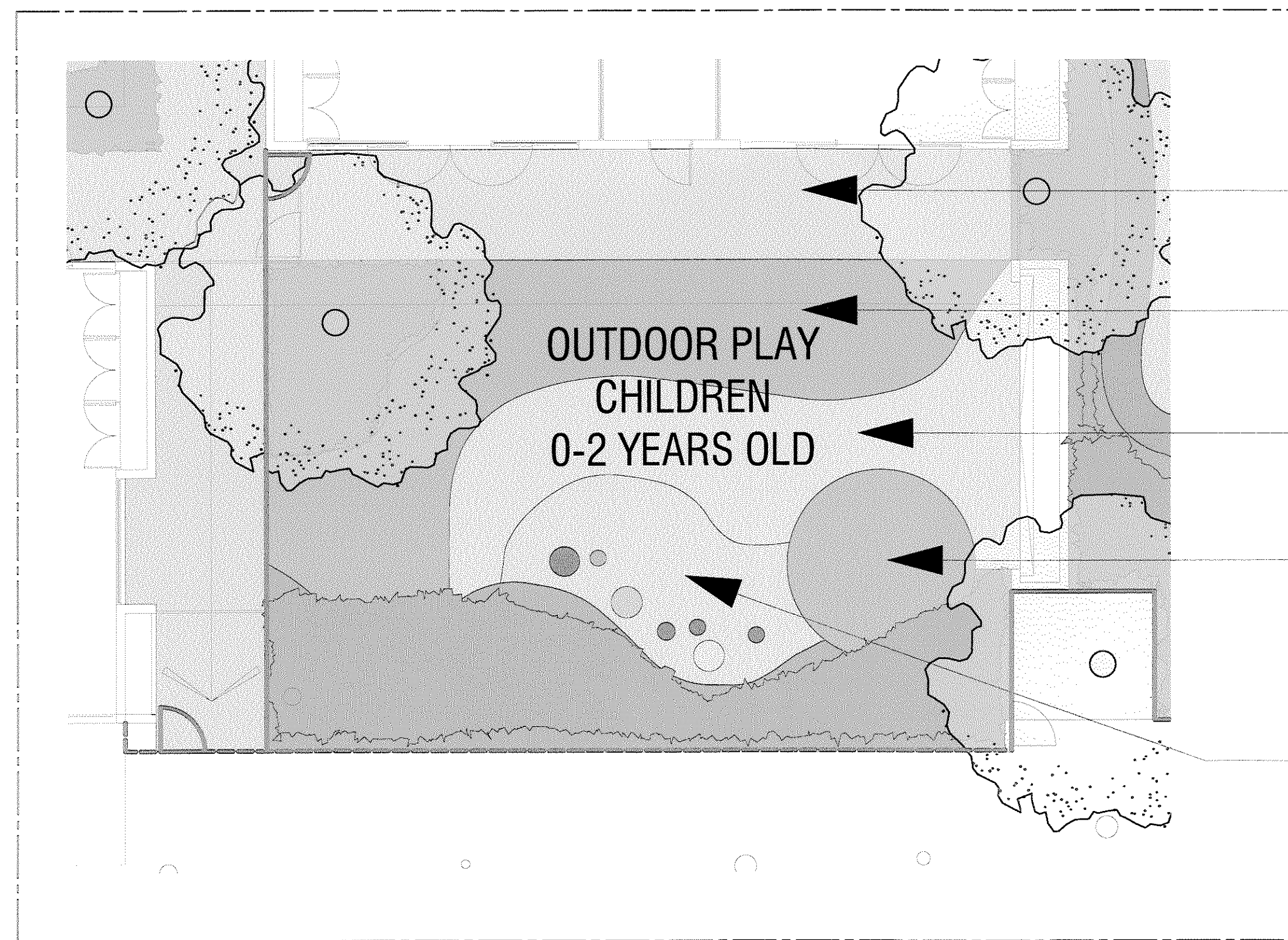

DETAIL PLAN B - CHILDCARE CENTRE

0 1 2 3 4 5 M SCALE 1:50@A1

- RUBBERISED CYCLE TRACK
- ARTIFICIAL TURF FOR BALL GAMES AND RUNNING
- RUBBERISED SOFTFALL FOR LOOSE PLAY EQUIPMENT
- LOW HEIGHT TIMBER PLATFORMS FOR PERFORMANCES, SEATING PLAYING
- SAND PIT FOR COGNITIVE AND SOCIAL PLAY
- MODERN THREE SIDED CUBBY FOR SOCIAL PLAY
- SHADE TREES TO CONNECT TO EXISTING CANOPY AND PROVIDE SHADE
- 1500MM HIGH POOL FENCE FOR SEPARATION BETWEEN YARDS
- RUBBERISED SOFTFALL FOR RUNNING AND HARD SURFACE OUTSIDE STORAGE AREAS
- MULCHED SOFTFALL FOR CLIMBING WALL
- * REFER PLAN 6 OF 7 FOR PLAY IMAGES**

- CONCRETE PATHWAY TO ACCESS BUILDING
- ARTIFICIAL TURF FOR BALL GAMES AND RUNNING
- RUBBERISED SOFTFALL FOR RUNNING AND HARD SURFACE OUTSIDE STORAGE AREAS
- ARTIFICIAL TURF MOUND FOR CLIMBING EXPERIENCE
- MULCHED SOFTFALL FOR CLIMBING OBJECTS
- * REFER PLAN 6 OF 7 FOR PLAY IMAGES**

LANDSCAPE CONCEPT PLAN LEGEND

- NATIVE PLANTINGS WITH SEASONAL COLOUR, 2 - 3M HIGH PLANTS USED FOR SCREENING ALONG BOUNDARIES, NON-POISONOUS, 1M HIGH LOW PLANTING USED IN CHILD PLAY AREAS AND TREES USED FOR SHADE AND HIGHLIGHTING ENTRIES AND WALKWAYS
- HARD WEARING CONCRETE PAVEMENTS USED IN AREAS OF HIGH PEDESTRIAN ACTIVITY, WHERE IMPLEMENT AS A BIKE TRACK OR WET PLAY AREA IN CHILD PLAY SPACES THE CONCRETE CAN BE DECORATED BY CHILDREN AND IN DETAIL DESIGN STAGE.
- LIMITED RUBBERISED SOFT FALL FOR LOOSE PLAY EQUIPMENT AND FIXED PLAY EQUIPMENT, PATTERNING ON SOFT FALL CURRENTLY SHOWN IS INDICATIVE ONLY, PATTERNS WILL BE DESIGNED TO SUIT AND COLOURS DETERMINED BY CONSULTATION.
- APPROVED MULCHED SOFTFALL MULCH FOR IMPACT ZONES AROUND SELECTED PLAY EQUIPMENT.
- ARTIFICIAL GRASSED AREAS FOR INFORMAL PLAY AND GATHERING AND IS DESIGNED FOR A HIGH LEVEL OF PEDESTRIAN ACTIVITY.
- FINE WASHED SAND IN LINED SAND PITS, WATER CAN BE ADDED IN BOWLS OR LOW DOSE PUMPS TO EXTEND THE PLAY EXPERIENCE.
- OPEN STYLE CUBBY HOUSE FOR CHILDREN'S PLAY, OPEN CUBBY HOUSES HAVE TWO SIDES ONLY, AN ELEVATED DECK AND ROOF STRUCTURE TO INCREASE SURVEILLANCE BUT FACILITATE SMALL SCALE PASSIVE PLAY EXPERIENCES.
- LOW HEIGHT TIMBER PLATFORMS FOR PASSIVE PLAY AND SEATING.
- LOW HEIGHT CLIMBING WALL PLAY EQUIPMENT TO SUPPLEMENT THE NATURE PLAY BASED PLAYGROUND, LOW HEIGHT WALL IS ILLUSTRATED ON THE LANDSCAPE ELEMENTS PLAN.
- PROPOSED TREES TO ADD SHADE, SOFTEN BUILT FORM AND ADD SEASONAL CHANGE TO THE LANDSCAPE SCHEME.

LANDSCAPE FENCING PLAN LEGEND

- 2400MM HIGH ACOUSTIC BOUNDARY FENCING TO SCREEN NEIGHBOURING PROPERTIES FROM SITE, FENCE WILL BE CONSTRUCTED OF RENDERED BLOCK WALL AND TIMBER SLAT FENCE PANEL FEATURE.
- 1500MM HIGH PLAYGROUND FENCING SURROUNDING THE PERIMETER OF PLAYSPACES TO PROVIDE SECURITY FOR CHILDREN AND ALLOW PASSIVE SURVEILLANCE.
- 1500MM HIGH GLASS FENCING ON THE EASTERN SIDE OF OUTDOOR PLAY AREA 0-2 AND TODDLERS PLAY AREA TO ALLOW UNINTERRUPTED VIEWS TOWARDS OVAL.

LANDSCAPE PLAY SPACES PHILOSOPHY

THE LANDSCAPE PLAY SPACES PHILOSOPHY IS TO PROVIDE A VARIETY OF SPACES AND SURFACE TREATMENTS FOR NATURE BASED PLAY, PROMOTE SOCIAL INTERACTION AND TO ACCOMMODATE LOOSE PLAY EQUIPMENT. HARD SURFACE TREATMENTS ARE LOCATED IN PLACES OF PREDICTED HIGH PEDESTRIAN OR CYCLE TRAFFIC. SOFTER LANDSCAPE SURFACES ARE FOCUSED AROUND EDGES AND TREE PLANTINGS AND ARE BORDERED THE HARD LANDSCAPE TO MAKE MAINTENANCE EASIER.

FOR APPROVAL

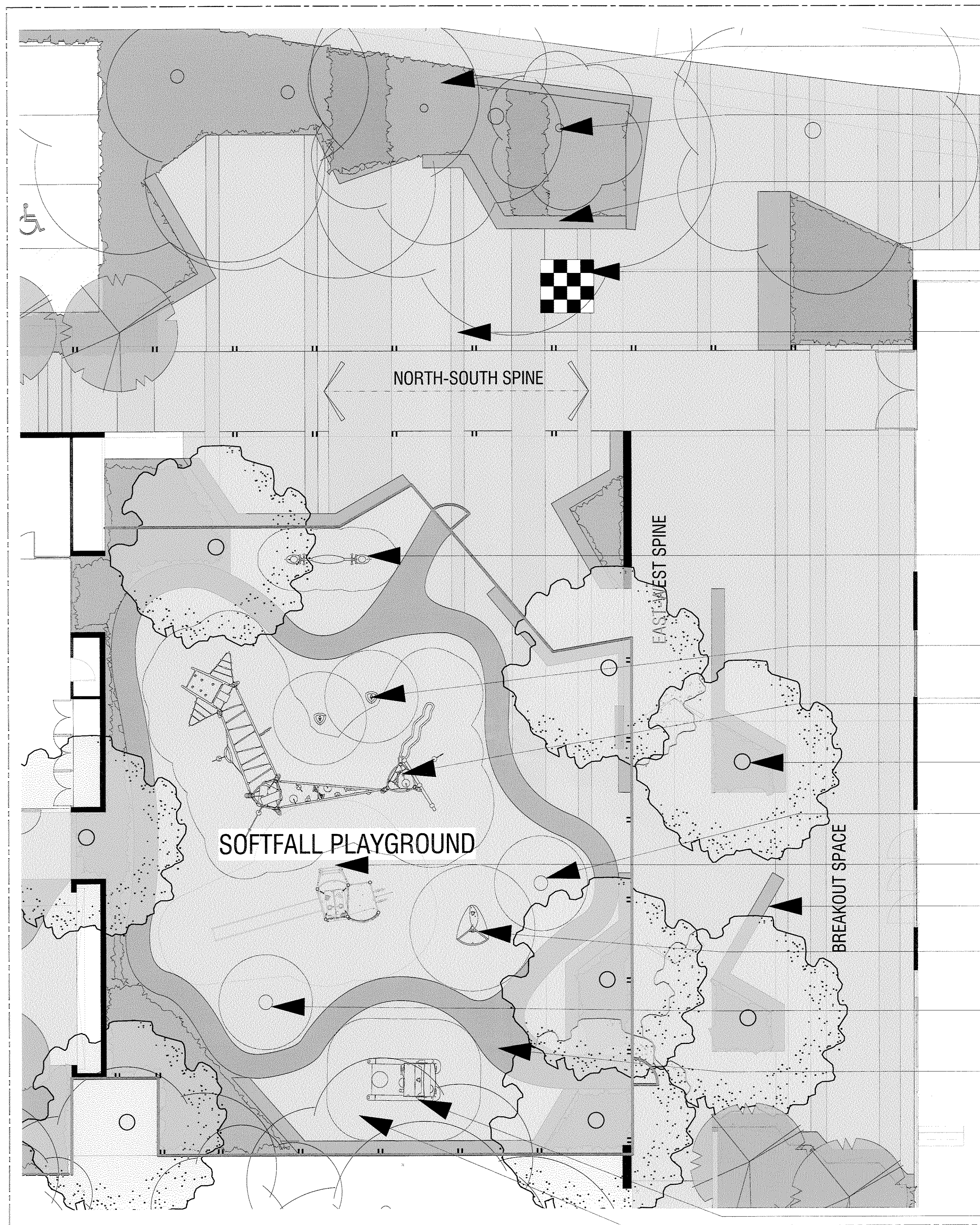

DENSELY PLANTED GARDEN BEDS SCREEN AREA FROM ROAD BUT ALLOW PASSIVE SURVEILLANCE INTO MAIN COURTYARD AREA

RETAIN EXISTING TREES TO SHADE GRASSED AREA

INSITU CONCRETE SEATING WALLS

GIANT SIZE CHESS SET

TURF WITH CONTRASTING GRASS SPECIES STRIPS TO CONTINUE PATTERN FROM CONCRETE WALKWAYS FOR INFORMAL PLAY AND GATHERING.

KOMPAN 'HOPPER' SEESAW. AGE 2-6

KOMPAN 'SPICA 3' AGE 6-12 ROTATING BALANCE PLAY EQUIPMENT.

KOMPAN 'ARCTURUS' PLAY EQUIPMENT. AGE 6-12

SHADE TREES TO CONNECT TO EXISTING CANOPY AND PROVIDE SHADE

KOMPAN 'SPINNER BOWL' AGE 4-15

KOMPAN 'VOLCANO' PLAY EQUIPMENT. AGE 6-12

INSITU CONCRETE SEATING WALLS

KOMPAN 'EXPLORER' PLAY EQUIPMENT. AGE 2-6

KOMPAN 'SPINNER BOWL' AGE 4-15

COLOURED CONCRETE BICYCLE TRACK

KOMPAN 'TRUCK' AGE 1-4

MULCHED SOFT FALL FOR PLAY EQUIPMENT

* REFER PLAN 6 OF 7 FOR PLAY IMAGES

LANDSCAPE CONCEPT PLAN LEGEND

- NATIVE PLANTINGS WITH SEASONAL COLOUR. 2-3M HIGH PLANTS USED FOR SCREENING ALONG BOUNDARIES. NON-POISONOUS. 1M HIGH LOW PLANTING USED IN CHILD PLAY AREAS AND TREES USED FOR SHADE AND HIGHLIGHTING ENTRIES AND WALKWAYS
- HIGHLIGHT PLANTS WITH YEAR ROUND FOLIAGE COLOUR TO SUBTLY DIRECT VISITORS TO THE FACILITY VEHICULAR AND PEDESTRIAN ENTRIES. HIGHLIGHT PLANTS ALSO ADD VIBRANT DETAIL TO LARGE MASS PLANTING AREAS.
- HARD WEARING CONCRETE PAVEMENTS USED IN AREAS OF HIGH PEDESTRIAN ACTIVITY. WHERE IMPLEMENT AS WET PLAY AREA IN CHILD PLAY SPACES THE CONCRETE CAN BE DECORATED BY CHILDREN AND IN DETAIL DESIGN STAGE.
- COLOURED CONCRETE BICYCLE TRACK TO ADD COLOUR TO THE PLAYGROUND SPACE AND PROVIDE A DISTINCT PATH FOR RUNNING AND RIDING BICYCLES.
- COLOURED CONCRETE WITH CONTRASTING CONCRETE PAVING PATTERNING USED TO PROVIDE SCALE AND INTEREST TO THE WALKWAYS.
- GRASSED AREAS WITH CONTRASTING GRASS SPECIES STRIPS TO CONTINUE PATTERN FROM CONCRETE WALKWAYS FOR INFORMAL PLAY AND GATHERING. GRASS IS IRRIGATED AND DESIGNED FOR A MEDIUM LEVEL OF PEDESTRIAN ACTIVITY.
- APPROVED MILLED SOFT FALL MULCH FOR IMPACT ZONES AROUND SELECTED PLAY EQUIPMENT.
- LOW HEIGHT RETAINING WALLS FOR SLOPED AREAS AND AS INFORMAL SEATING WALLS THROUGHOUT THE CENTRE.
- THE CENTRAL COURTYARD SPACE FEATURES A SOFT FALL PLAYGROUND WITH A COLOURED CONCRETE BIKE TRACK AND EQUIPMENT FOR CHILDREN AGED BETWEEN 2-15. PLAYGROUND EQUIPMENT IS ILLUSTRATED ON THE LANDSCAPE ELEMENTS PLAN.
- PROPOSED TREES TO ADD SHADE, SOFTEN BUILT FORM AND ADD SEASONAL CHANGE TO THE LANDSCAPE SCHEME.
- EXISTING TREES TO BE RETAINED ON SITE. FOR INFORMATION ON TREE HEALTH REFER TREE REPORT FOR NOMINATED SPECIES AND CONDITION OF TREES.

LANDSCAPE FENCING PLAN LEGEND

- 2400MM HIGH ACOUSTIC BOUNDARY FENCING TO SCREEN NEIGHBOURING PROPERTIES FROM SITE. FENCE WILL BE CONSTRUCTED OF RENDERED BLOCK WALL AND TIMBER SLAT FENCE PANEL FEATURE.
- 1500MM HIGH PLAYGROUND FENCING SURROUNDING THE PERIMETER OF PLAYSPACES TO PROVIDE SECURITY FOR CHILDREN AND ALLOW PASSIVE SURVEILLANCE.
- 1500MM HIGH GLASS FENCING ON THE EASTERN SIDE OF OUTDOOR PLAY AREA 0-2 AND TODDLERS PLAY AREA TO ALLOW UNINTERRUPTED VIEWS TOWARDS OVAL.

LANDSCAPE PLAY SPACES PHILOSOPHY

THE LANDSCAPE CENTRAL PLAY SPACE IS TO PROVIDE THREE UNIQUE SPACES THAT OFFER A VARIETY OF EXPERIENCES AND ACTIVITIES FOR ALL AGES. THESE SPACES INCLUDE; A TURF AREA WITH INSITU CONCRETE SEATING WALLS SHADED BY EXISTING TREES. A SOFT FALL PLAYGROUND THAT WILL FEATURE A BIKE TRACK AND EQUIPMENT FOR CHILDREN AGED BETWEEN 2-15 AND A BREAKOUT GATHERING SPACE FROM THE COMMUNITY CENTRE FEATURING INSITU CONCRETE SEATING WALLS SHADED BY PROPOSED TREES.

FOR APPROVAL

DETAIL PLAN C - MAIN COURTYARD AREA

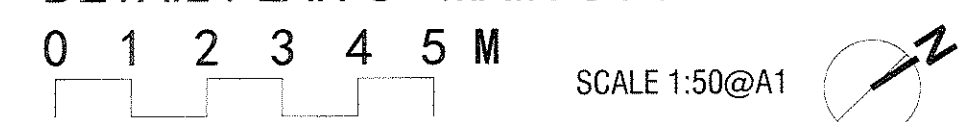

PROPOSED STOREY PARK COMMUNITY HALL AND CHILDCARE CENTRE
Community centre, Childcare ages 0-5, Administrative block and Parking arrangements

Sydney
Studio 12 Level 5 35 Buckingham St
Surry Hills NSW 2010
Tel +61 2 8396 9500 Fax +61 2 8396 9555
E-mail sydney@modedesign.com.au
Architect R P O'Brien Registration No 7176
Brisbane Sunshine Coast Sydney Melbourne Darwin Gold Coast

PROJECT No: 10157SYD
DATE: 29/10/2012
SCALE: 1:50@A1
DRAWING No: DD 03 OF 7
REVISION: E